



# VALVES AND COCKS VENTILE UND HÄHNE

Three way cock G - G - G  
Dreiwegekükenhahn G - G - G

**40110**

**Dimensions • Baumaße**

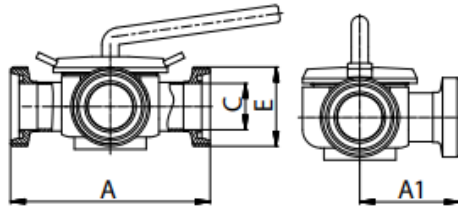

DN	A	C	A1	E	F	R	L	Rd x s	kg
				<b>DIN 405</b>					
40	184,5	38	92,2	65x1/6"					
50	231,5	50	115,8	78x1/6"					

Three way cock S - S - S  
Dreiwegekükenhahn S - S - S

**40111**

**Dimensions • Baumaße**

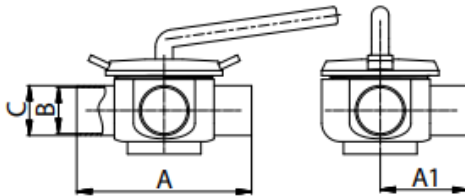

DN	A	A1	B	C	E	F	R	L	Rd x s	kg
40	140,5	70,2	38	41						
50	185,5	92,8	50	53						

Three way cock C - C - C  
Dreiwegekükenhahn C - C - C

**40119**

**Dimensions • Baumaße**

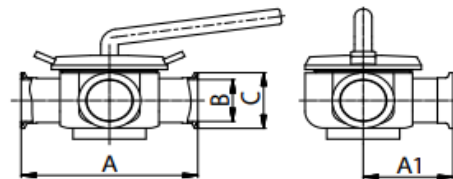

DN	A	A1	B	C	E	F	R	L	Rd x s	kg
40	165,9	82,9	38	50,5						
50	210,9	105,5	50	64						

Three way ball valve G - G - G  
3-Teilig-Kugelventil G - G - G

**40210**

**Dimensions • Baumaße**

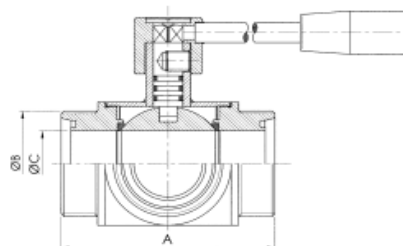

DN	A	B	C	E	E	F	R	L	Rd x s	kg
		<b>DIN 405</b>								
25	136	52x1/6"	25							
32	138	58x1/6"	31							
40	158	65x1/6"	37							
50	170	78x1/6"	49							
65	204	95x1/6"	66							
80	130	110x1/4"	81							
100	264	130x1/4"	100							
125	346	160x1/4"	120							

Three way ball valve PN - PN - PN  
3-Teilung-Kugelventil PN - PN - PN

**40240**

**Dimensions • Baumaße**

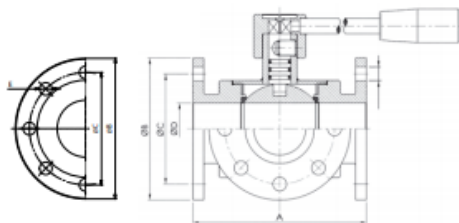

DN	A	B	C	D	E	F	R	L	Rd x s	kg
25	150	115	85	25	14x4					
32	180	140	100	31	18x4					
40	200	150	110	37	18x4					
50	220	165	125	49	18x4					
65	240	185	145	66	18x4					
80	260	200	160	81	18x8					
100	300	220	180	100	18x8					
125	380	250	210	120	18x8					

Straight way ball valve S - S  
Kugelventil S - S

**40510**

**Dimensions • Baumaße**

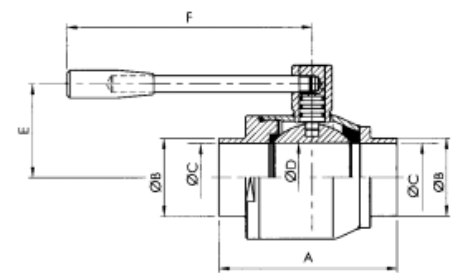

DN	A	B	C	D	E	F	R	L	Rd x s	kg
15	78	21	16	16	40	90				
20	78	25	20	19	40	90				
25	84	31	26	24	44	146				
32	106	37	32	33	50	146				
40	124	43	40	40	64	185				
50	134	55	49	49,5	68	185				
65	145	72	65	65	95	243				
80	179	87	79	79	104	243				
100	205	106	99	99	122	273				
125	225	132	119	119	135	273				

Straight way ball valve G - S  
Kugelventil G - S

**40520**

**Dimensions • Baumaße**

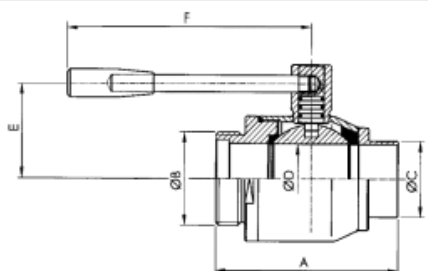

DN	A	B	C	D	E	F	R	L	Rd x s	kg
		<b>DIN 405</b>								
25	86	52x1/6"	31	24	44	146				
32	104	58x1/6"	37	33	50	146				
40	125	65x1/6"	43	40	64	185				
50	134	78x1/6"	55	49,5	68	185				
65	145	95x1/6"	72	65	95	243				
80	179	110x1/4"	87	79	104	243				
100	205	130x1/4"	106	99	122	273				
125	225	160x1/4"	132	119	135	273				

Straight way ball valve G - G  
Kugelventil G - G

**40530**

**Dimensions • Baumaße**

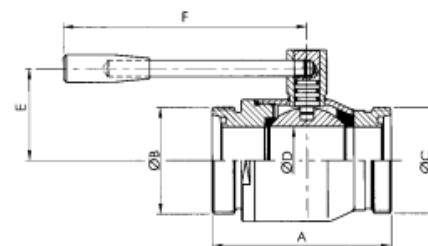

DN	A	B/C	D	E	F	F	R	L	Rd x s	kg
		<b>DIN 405</b>								
25	89	52x1/6"	24	44	146					
32	113	58x1/6"	33	50	146					
40	124	65x1/6"	40	64	185					
50	134	78x1/6"	49,5	68	185					
65	146	95x1/6"	65	95	243					
80	179	110x1/4"	79	104	243					
100	205	130x1/4"	99	122	273					
125	225	160x1/4"	119	135	273					

# VALVES AND COCKS VENTILE UND HÄHNE

Straight way ball valve S - K/M Kugelventil S - K/M	40540	Dimensions • Baumaße											
		DN	A	B	C	D	E	F	R	L	Rd x s	kg	
			DIN 405										
			25	89	31	52x1/6"	24	44	146				
			32	120	37	58x1/6"	33	50	146				
			40	128	43	65x1/6"	40	64	185				
			50	140	55	78x1/6"	49,5	68	185				
			65	152	72	95x1/6"	65	95	243				
			80	190	87	110x1/4"	79	104	243				
			100	221	106	130x1/4"	99	122	273				
			125	259	132	160x1/4"	119	135	273				

Straight way ball valve G - K/M Kugelventil G - K/M	40550	Dimensions • Baumaße										
		DN	A	B/C	D	E	F	G	R	L	Rd x s	kg
			DIN 405									
			25	92	52x1/6"	24	44	146				
			32	118	58x1/6"	33	50	146				
			40	128	65x1/6"	40	64	185				
			50	140	78x1/6"	49,5	68	185				
			65	152	95x1/6"	65	95	243				
			80	190	110x1/4"	79	104	243				
			100	221	130x1/4"	99	122	273				
			125	259	160x1/4"	119	135	273				

Straight way ball valve K/M - K/M Kugelventil K/M - K/M	40560	Dimensions • Baumaße										
		DN	A	C	D	E	F	F	R	L	Rd x s	kg
			DIN 405									
			25	92	52x1/6"	24	44	146				
			32	123	58x1/6"	33	50	146				
			40	131	65x1/6"	40	64	185				
			50	143	78x1/6"	49,5	68	185				
			65	160	95x1/6"	65	95	243				
			80	190	110x1/4"	79	104	243				
			100	235	130x1/4"	99	122	273				
			125	259	160x1/4"	119	135	273				

Straight way ball valve G - PN Kugelventil G - PN	40570	Dimensions • Baumaße										
		DN	A	B	C	D	E	F	G	L	Rd x s	kg
			DIN 405									
			25	86	52x1/6"	85	24	44	14x4	115	146	
			32	104	58x1/6"	100	33	50	18x4	140	146	
			40	107	65x1/6"	110	40	64	18x4	150	185	
			50	117	78x1/6"	125	49,5	68	18x4	165	185	
			65	141	95x1/6"	145	65	95	18x4	185	243	
			80	156	110x1/4"	160	79	104	18x4	200	243	
			100	181	130x1/4"	180	99	122	18x8	220	273	
			125	201	160x1/4"	210	119	135	18x8	250	273	

Two pieces ball cock G - G  
2-Teilung-Kugelhahn G - G

**40640**

**Dimensions • Baumaße**

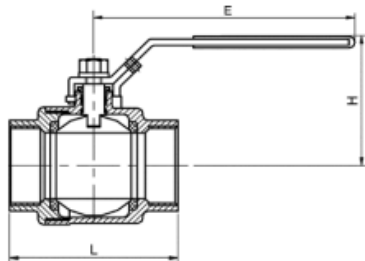

DN	L	E	H	D	E	F	R	L	Rd x s	kg
1/4"	52	90	55							
3/8"	52	90	55							
1/2"	55	105	55							
3/4"	65	115	60							
1"	72	120	70							
1 1/4"	83	145	75							
1 1/2"	95	175	90							
2"	110	175	100							
2 1/2"	144	210	130							
3"	170	230	140							

Three pieces ball cock S - S  
3-Teilung-Kugelhahn S - S

**40650**

**Dimensions • Baumaße**

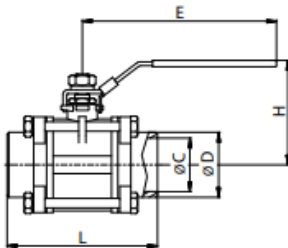

DN	L	E	H	C	D	F	R	L	Rd x s	kg
8	63	95	46	11	17					
10	63	95	50	12	17					
15	75	103	56	15	21,3					
20	80	118	66	20	26,7					
25	90	135	72	25	33,4					
32	110	135	83	32	42,2					
40	120	160	88	38	48,3					
50	140	173	100	50	60,3					
65	165	216	127	65	74					
80	202	232	138	80	91					
100	252	330	171	100	110					

Three pieces ball cock S - S  
for orbital welding  
3-Teilung-Kugelhahn S - S für Orbital  
Schweißen

**40660**

**Dimensions • Baumaße**

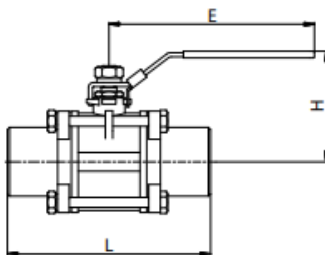

DN	L	E	H	C	D	F	R	G	Rd x s	kg
8	100	95	46	11	17					
10	100	95	50	12	17					
15	125	103	56	15	21,3					
20	130	118	66	20	26,7					
25	140	135	72	25	33,4					
32	168	135	83	32	42,2					
40	178	160	88	38	48,3					
50	200	173	100	50	60,3					
65	245	216	127	65	74					
80	282	232	138	80	91					
100	332	330	171	100	110					

Three pieces ball cock G - G  
3-Teilung-Kugelhahn G - G

**40670**

**Dimensions • Baumaße**

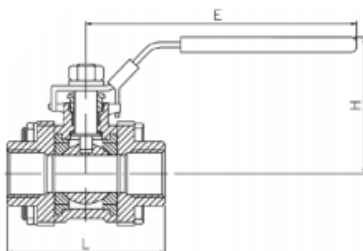

DN	L	E	H	D	E	F	R	G	Rd x s	kg
1/4"	51	95	46							
3/8"	65	95	50							
1/2"	74	103	56							
3/4"	70	118	66							
1"	89	135	72							
1 1/4"	108	135	83							
1 1/2"	108	160	88							
2"	140	173	100							
2 1/2"	168	216	127							
3"	190	232	138							
4"	240	330	171							



# VALVES AND COCKS VENTILE UND HÄHNE

Three pieces ball cock S - S with AT SR 4405 (or DA 4410)  
3-Teilung-Kugelhahn S - S mit AT SR 4405 (oder DA 4410)

**4065 P05** Dimensions • Baumaße

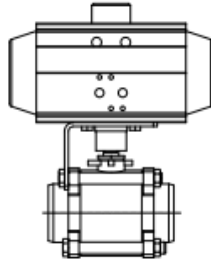

4065 P10	DN	A	B	C	L	Rd x s	kg
	10						
	15						
	20						
	25						
	32						
	40						
	50						
	65						
	80						
	100						

Bracket  
Konsole für Kugelhahn

**40770** Dimensions • Baumaße

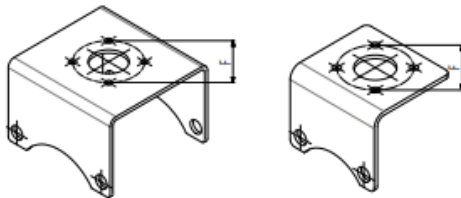

	DN	A	D	L	Rd x s	kg
	10		F04			
	15		F04			
	20		F04			
	25		F04			
	32		F04/F05			
	40		F05			
	50		F07			
	65		F07			
	80		F07			
	100		F07			

Catch driver for 3-pieces ball cock  
Kupplung für 3-Teilung-Kugelhahn

**40780** Dimensions • Baumaße

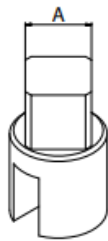

	A	B	C	D	L	Rd x s	kg
	11x11						
	14x14						
	17x17						
	22x22						



**Butterfly valve - variants control and signaling**

**Scheibenventil - variaten kontrolle und signalisierung**

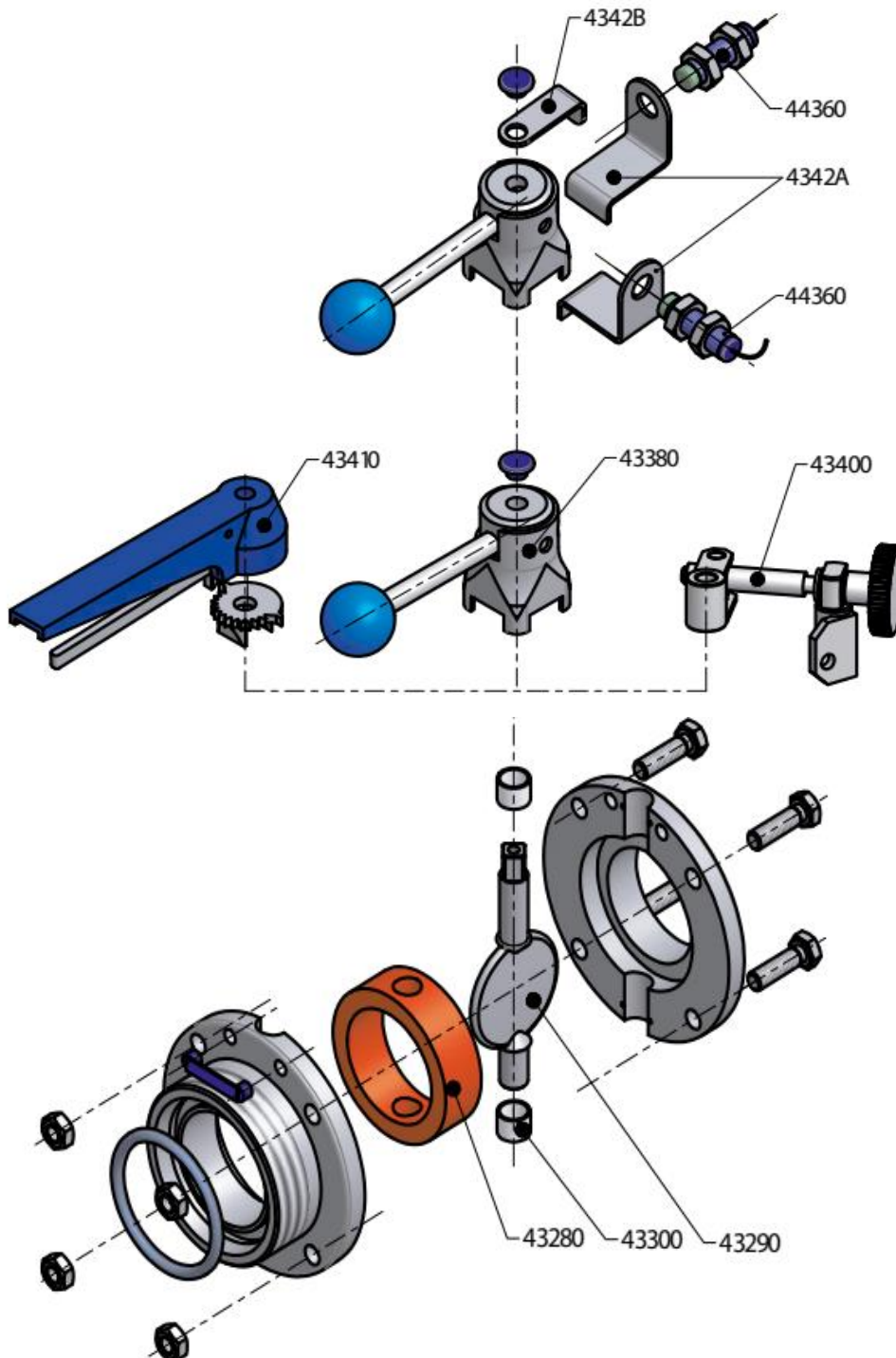

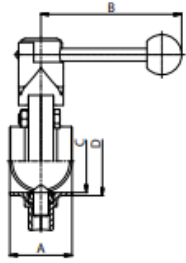
Butterfly valve S - S Scheibenventil S - S	43010	Dimensions • Baumaße										
		DN	A	B	C	D	E	F	R	L	Rd x s	kg
	15	50	110	15	18							
	20	50	110	19	22							
	25	40	114	26	31							
	32	42	114	32	37							
	40	50	140	38	43							
	50	50	140	50	55							
	65	50	140	66	72							
	80	60	174	81	87							
	100	64	174	100	106							
	125	100	210	125	138							
150	100	210	150	164								

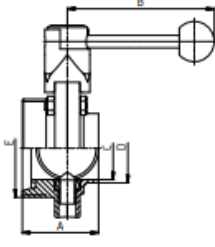
Butterfly valve G - S Scheibenventil G - S	43020	Dimensions • Baumaße										
		DN	A	B	C	D	E	F	R	L	Rd x s	kg
												
							<b>DIN 405</b>					
	15	58	110	15	18	34x1/8"						
	20	58	110	19	22	44x1/6"						
	25	52	114	26	31	52x1/6"						
	32	53	114	32	37	58x1/6"						
	40	61	140	38	43	65x1/6"						
	50	61	140	50	55	78x1/6"						
	65	63	140	66	72	95x1/6"						
	80	80	174	81	87	110x1/4"						
100	84	174	100	106	130x1/4"							
125	106	210	125	138	160x1/4"							
150	112	210	150	164	190x1/4"							

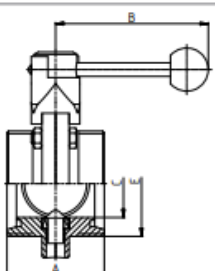
Butterfly valve G - G Scheibenventil G - G	43030	Dimensions • Baumaße										
		DN	A	B	C	E	F	F	R	L	Rd x s	kg
												
	15	66	110	15	34x1/8"							
	20	66	110	19	44x1/6"							
	25	64	114	26	52x1/6"							
	32	64	114	32	58x1/6"							
	40	72	140	38	65x1/6"							
	50	72	140	50	78x1/6"							
	65	76	140	66	95x1/6"							
	80	100	174	81	110x1/4"							
100	104	174	100	130x1/4"								
125	112	210	125	160x1/4"								
150	124	210	150	190x1/4"								

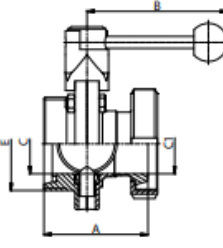
Butterfly valve G - K/M Scheibenventil G - K/M	43040	Dimensions • Baumaße										
		DN	A	B	C	C1	E	R	L	Rd x s	kg	
												
	15	73	110	15	16	38x1/8"						
	20	74	110	19	20	44x1/6"						
	25	74	114	26	26	52x1/6"						
	32	78	114	32	32	58x1/6"						
	40	87	140	38	38	65x1/6"						
	50	89	140	50	50	78x1/6"						
	65	95	140	66	66	95x1/6"						
	80	117	174	81	81	110x1/4"						
100	128	174	100	100	130x1/4"							
125	138	210	125	125	160x1/4"							
150	147	210	150	150	190x1/4"							

# VALVES AND COCKS VENTILE UND HÄHNE

Butterfly valve K/M - S Scheibenventil K/M - S	43050	Dimensions • Baumaße									
		DN	A	B	C	C1	E	R	L	Rd x s	kg
		<b>DIN 405</b>									
		15	65	110	15	16	34x1/8"				
		20	66	110	19	20	44x1/6"				
		25	60	114	26	26	52x1/6"				
		32	65	114	32	32	58x1/6"				
		40	74	140	38	38	65x1/6"				
		50	76	140	50	50	78x1/6"				
		65	80	140	66	66	95x1/6"				
		80	95	174	81	81	110x1/4"				
		100	106	174	100	100	130x1/4"				
125	132	210	125	125	160x1/4"						
150	135	210	150	150	190x1/4"						

Butterfly valve K/M - K/M Scheibenventil K/M - K/M	43060	Dimensions • Baumaße									
		DN	A	B	C	E	F	G	R	L	Rd x s
		<b>DIN 405</b>									
		15	80	110	16	38x1/8"					
		20	82	110	20	44x1/6"					
		25	80	114	26	52x1/6"					
		32	88	114	32	58x1/6"					
		40	98	140	38	65x1/6"					
		50	102	140	50	78x1/6"					
		65	110	140	66	95x1/6"					
		80	130	174	81	110x1/4"					
		100	148	174	100	130x1/4"					
125	164	210	125	160x1/4"							
150	170	210	150	190x1/4"							

Butterfly valve PN - G Scheibenventil PN - G	4307B	Dimensions • Baumaße										
		DN	A	B	C	E	d	d1	F	L	Rd x s	kg
		<b>DIN 405</b>										
		25	106	114	26	52x1/6"	85x4	115	14			
		32	106	114	32	58x1/6"	100x4	140	18			
		40	110	140	38	65x1/6"	110x4	150	18			
		50	112	140	50	78x1/6"	125x4	165	18			
		65	122	140	66	95x1/6"	145x4	185	18			
		80	135	174	81	110x1/4"	160x8	200	18			
		100	140	174	100	130x1/4"	180x8	220	18			

Butterfly valve PN - PN Scheibenventil PN - PN	43080	Dimensions • Baumaße									
		DN	A	B	C	E	F	F	R	L	Rd x s
		25	84	114	26						
		32	86	114	32						
		40	100	140	38						
		50	100	140	50						
		65	100	140	66						
		80	120	174	81						
		100	146	174	100						
		125	168	210	125						
		150	188	210	150						



# VALVES AND COCKS VENTILE UND HÄHNE

Compact flange butterfly valve PN - PN  
Kompaktzwischenflansch-  
Scheibenventil PN - PN

**43081**

**Dimensions • Baumaße**

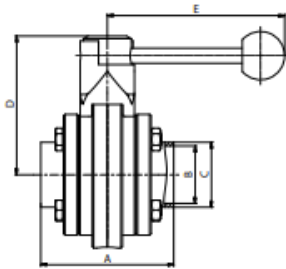

DN	A	B	C	D	E	F	R	L	Rd x s	kg
25	78	26	31	87	117					
32	78	32	37	90	117					
40	88	38	43	92	126					
50	88	50	53	98,5	126					
65	88	66	72	107,5	126					
80	120	81	87	120	153					
100	124	100	106	130	153					
125	140	125	132	160	205					
150	160	150	157	175	205					

Butterfly valve C - C  
Scheibenventil C - C

**43090**

**Dimensions • Baumaße**

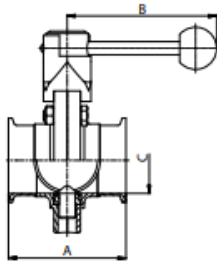

DN	A	B	C	D	E	F	R	L	Rd x s	kg
25	64	114	26							
32	72	114	32							
40	72	140	38							
50	72	140	50							
65	80	140	66							
80	84	174	81							
100	102	174	100							

Butterfly valve S - C  
Scheibenventil S - C

**43101**

**Dimensions • Baumaße**

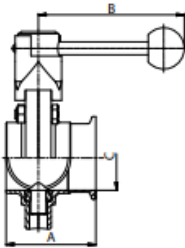

DN	A	B	C	D	E	F	R	L	Rd x s	kg
25	59,5	114	26							1,3
32	61,5	114	32							1,4
40	69,5	140	38							1,6
50	69,5	140	50							1,8
65	76	140	66							2,2
80	86	174	81							3,9
100	90	174	100							4,6
125	126	210	125							
150	126	210	150							

Tee with one butterfly valve G - G - G  
Mehrwege-Scheibenventil G - G - G

**43110**

**Dimensions • Baumaße**

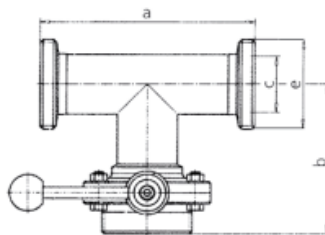

DN	A	B	C	E	F	F	R	L	Rd x s	kg
				<b>DIN 405</b>						
25	144	100	26	52x1/6"						
32	154	106	32	58x1/6"						
40	164	119	38	65x1/6"						
50	186	127	50	78x1/6"						
65	210	141	66	95x1/6"						
80	230	168	81	110x1/4"						
100	260	182	100	130x1/4"						
125	446	291,5	125	160x1/4"						
150	530	335	150	190x1/4"						

Tee with one butterfly valve G - G - G Mehrwege-Scheibenventil G - G - G		43120 Dimensions • Baumaße										
DN	A	B	C	E	F	G	R	L	Rd x s	kg		
				<b>DIN 405</b>								
25	172	72	26	52x1/6"								
32	183	77	32	58x1/6"								
40	201	82	38	65x1/6"								
50	222	93	50	78x1/6"								
65	146	105	66	95x1/6"								
80	283	115	81	110x1/4"								
100	312	130	100	130x1/4"								
125	514,5	223	125	160x1/4"								
150	600	265	150	190x1/4"								

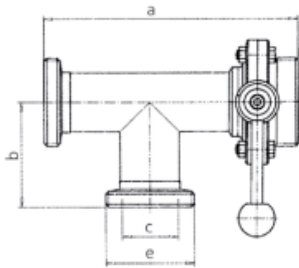

Tee with one butterfly valve G - G - G Mehrwege-Scheibenventil G - G - G		43130 Dimensions • Baumaße										
DN	A	B	C	E	F	G	R	L	Rd x s	kg		
				<b>DIN 405</b>								
25	172	72	26	52x1/6"								
32	183	77	32	58x1/6"								
40	201	82	38	65x1/6"								
50	222	93	50	78x1/6"								
65	146	105	66	95x1/6"								
80	283	115	81	110x1/4"								
100	312	130	100	130x1/4"								
125	514,5	223	125	160x1/4"								
150	600	265	150	190x1/4"								

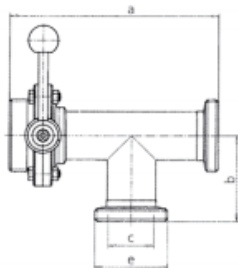

Tee with two butterfly valves G - G - G Mehrwege-Scheibenventil G - G - G		43140 Dimensions • Baumaße										
DN	A	B	C	E	F	G	R	L	Rd x s	kg		
				<b>DIN 405</b>								
25	200	72	26	52x1/6"								
32	212	77	32	58x1/6"								
40	238	82	38	65x1/6"								
50	258	93	50	78x1/6"								
65	282	105	66	95x1/6"								
80	336	115	81	110x1/4"								
100	364	130	100	130x1/4"								
125	583	223	125	160x1/4"								
150	670	265	150	190x1/4"								

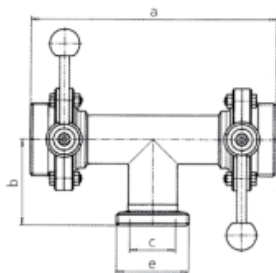

Tee with two butterfly valves G - G - G Mehrwege-Scheibenventil G - G - G		43150 Dimensions • Baumaße										
DN	A	B	C	E	F	G	R	L	Rd x s	kg		
				<b>DIN 405</b>								
25	172	100	26	52x1/6"								
32	183	106	32	58x1/6"								
40	201	119	38	65x1/6"								
50	222	127	50	78x1/6"								
65	246	141	66	95x1/6"								
80	283	168	81	110x1/4"								
100	312	182	100	130x1/4"								
125	514,5	291,5	125	160x1/4"								
150	600	335	150	190x1/4"								

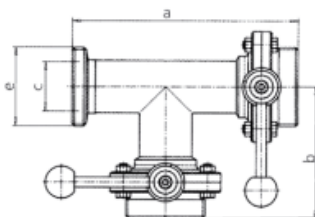

Tee with two butterfly valves G - G - G Mehrwege-Scheibenventil G - G - G	43160	Dimensions • Baumaße										
		DN	A	B	C	E	F	R	L	Rd x s	kg	
		DIN 405										
		25	172	100	26	52x1/6"						
		32	183	106	32	58x1/6"						
		40	201	119	38	65x1/6"						
		50	222	127	50	78x1/6"						
		65	246	141	66	95x1/6"						
		80	283	168	81	110x1/4"						
		100	312	182	100	130x1/4"						
		125	514,5	291,5	125	160x1/4"						
		150	600	335	150	190x1/4"						

Tee with three butterfly valves G - G - G Mehrwege-Scheibenventil G - G - G	43170	Dimensions • Baumaße											
		DN	A	B	C	E	F	F	R	L	Rd x s	kg	
		DIN 405											
		25	200	100	26	52x1/6"							1,34
		32	212	106	32	58x1/6"							1,39
		40	238	119	38	65x1/6"							1,56
		50	258	127	50	78x1/6"							1,76
		65	282	141	66	95x1/6"							2,24
		80	336	168	81	110x1/4"							3,91
		100	364	182	100	130x1/4"							4,56
		125	583	291,5	125	160x1/4"							
		150	670	335	150	190x1/4"							

Gasket for butterfly valve Dichtung für Scheibenventil	43280	Dimensions • Baumaße										
		DN	D1	D2	B	C	E	F	R	L	Rd x s	kg
		25	26	40	20							
		32	32	48	20							
		40	38	54	21							
		50	51	67	21							
		65	67	85	22							
		80	82	101	24							
		100	101	116	26							
		125	125	151	29							
		150	150	175	29							

Butterfly disc Drehklappe für Scheibenventil	43290	Dimensions • Baumaße										
		DN	A	B	C	D	E	F	R	L	Rd x s	kg
		25	80	9,5		26						0,05
		32	87,6	9,5		32						0,06
		40	93,6	9,5		38						0,10
		50	111	9,5		50						0,15
		65	128,1	9,5		66						0,24
		80	143,8	9,5		81						0,39
		100	163,9	9,5		100						0,63
		125	214	14,0		125						1,16
		150	245,8	14,0		150						2,00

Butterfly valve bushing (pair)  
Scheibenventil-buchse (paar)

**43300** Dimensions • Baumaße



DN	D1	D2	L1	E	R	L	Rd x s	kg
25	10	12	5					
32	10	12	5					
40	12	14	10					
50	12	14	10					
65	12	14	10					
80	14	16	12					
100	14	16	12					
125	18	20	18					
150	18	20	18					

Tee with two butterfly valves G - G - G  
with combination handle

Mehrwege-Scheibenventil G - G - G mit Schaltkombination

**43310** Dimensions • Baumaße

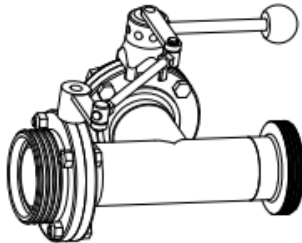

DN	A	B	C	E	R	L	Rd x s	kg
25								
32								
40								
50								
65								
80								
100								
125								
150								

Tee with two butterfly valves G - G - G  
with combination handle

Mehrwege-Scheibenventil G - G - G mit Schaltkombination

**43320** Dimensions • Baumaße

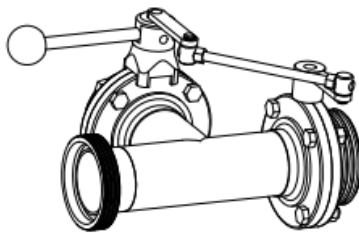

DN	A	B	C	E	R	L	Rd x s	kg
25								
32								
40								
50								
65								
80								
100								
125								
150								

Tee with two butterfly valves G - G - G  
with combination handle

Mehrwege-Scheibenventil G - G - G mit Schaltkombination

**43330** Dimensions • Baumaße

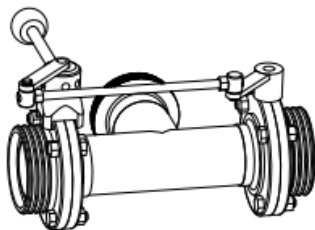

DN	A	B	C	E	R	L	Rd x s	kg
25								
32								
40								
50								
65								
80								
100								
125								
150								

Butterfly valve SMS S - S Scheibenventil SMS S - S	<b>45010</b>	<b>Dimensions • Baumaße</b>									
		<b>DN</b>	<b>A</b>	<b>B</b>	<b>C</b>	<b>D</b>	<b>F</b>	<b>F</b>	<b>R</b>	<b>L</b>	<b>Rd x s</b>
	<b>25</b>	40	22	25	102,5						
	<b>38</b>	50	35	38	102,5						
	<b>51</b>	50	48	51	132,5						
	<b>63,5</b>	50	60,5	63,5	132,5						
	<b>76,1</b>	60	72,1	76,1	155						
	<b>101,6</b>	64	97,6	101,6	155						

Butterfly valve SMS S - G Scheibenventil SMS S - G	<b>45020</b>	<b>Dimensions • Baumaße</b>									
		<b>DN</b>	<b>A</b>	<b>B</b>	<b>C</b>	<b>D</b>	<b>E</b>	<b>G</b>	<b>R</b>	<b>L</b>	<b>Rd x s</b>
	<b>25</b>	52	22	25	102,5					<b>DIN 405</b>	
	<b>38</b>	61	35	38	102,5					40x1/6"	
	<b>51</b>	61	48	51	132,5					60x1/6"	
	<b>63,5</b>	63	60,5	63,5	132,5					70x1/6"	
	<b>76,1</b>	80	72,1	76,1	155					85x1/6"	
	<b>101,6</b>	84	97,6	101,6	155					98x1/6"	

Butterfly valve SMS G - G Scheibenventil SMS G - G	<b>45030</b>	<b>Dimensions • Baumaße</b>									
		<b>DN</b>	<b>A</b>	<b>B</b>	<b>D</b>	<b>E</b>	<b>F</b>	<b>F</b>	<b>R</b>	<b>L</b>	<b>Rd x s</b>
	<b>25</b>	64	22	102,5						<b>DIN 405</b>	
	<b>38</b>	72	35	102,5						40x1/6"	
	<b>51</b>	72	48	132,5						60x1/6"	
	<b>63,5</b>	76	60,5	132,5						70x1/6"	
	<b>76,1</b>	100	72,1	155						85x1/6"	
	<b>101,6</b>	104	97,6	155						98x1/6"	

Butterfly valve SMS G - K/M Scheibenventil SMS G - K/M	<b>45040</b>	<b>Dimensions • Baumaße</b>									
		<b>DN</b>	<b>A</b>	<b>B</b>	<b>D</b>	<b>E</b>	<b>F</b>	<b>G</b>	<b>R</b>	<b>L</b>	<b>Rd x s</b>
	<b>25</b>	67,5	22	102,5						<b>DIN 405</b>	
	<b>38</b>	77	35	102,5						40x1/6"	
	<b>51</b>	78	48	132,5						60x1/6"	
	<b>63,5</b>	80	60,5	132,5						70x1/6"	
	<b>76,1</b>	99	72,1	155						85x1/6"	
	<b>101,6</b>	103	97,6	155						98x1/6"	

Butterfly valve SMS K/M - S  
Scheibenventil SMS K/M - S

45050

Dimensions • Baumaße

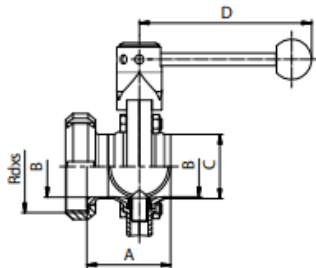

DN	A	B	C	D	F	F	R	L	Rd x s	kg
25	55,5	22	25	102,5					<b>DIN 405</b>	
38	66	35	38	102,5					40x1/6"	
51	67	48	51	132,5					60x1/6"	
63,5	67	60,5	63,5	132,5					70x1/6"	
76,1	79	72,1	76,1	155					85x1/6"	
101,6	83	97,6	101,6	155					98x1/6"	
									125x1/4"	

Butterfly valve SMS K/M - K/M  
Scheibenventil SMS K/M - K/M

45060

Dimensions • Baumaße

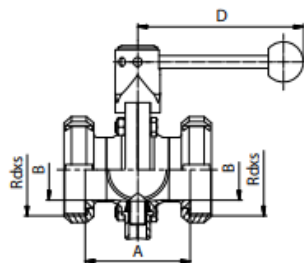

DN	A	B	D	D	E	G	R	L	Rd x s	kg
25	55,5	22	102,5						<b>DIN 405</b>	
38	66	35	102,5						40x1/6"	
51	67	48	132,5						60x1/6"	
63,5	67	60,5	132,5						70x1/6"	
76,1	79	72,1	155						85x1/6"	
101,6	83	97,6	155						98x1/6"	
									125x1/4"	

Handle for butterfly valve  
Zuggriff für Scheibenventil

43380

Dimensions • Baumaße

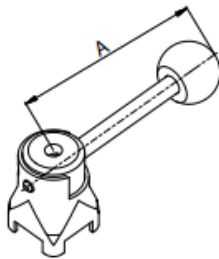

DN	A	B	D	E	F	F	R	L	Rd x s	kg
25-40	114									
50-65	140									
80-100	174									
125-150	210									

Handle-screw  
Handgriff stufenlos

43400

Dimensions • Baumaße

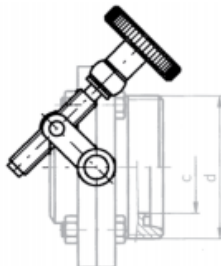

DN	A	B	D	E	F	G	R	L	Rd x s	kg
25										
32										
40										
50										
65										
80										
100										
125										
150										



Bracket of pneumatic actuator Haltekonsole universal	<b>43900</b>	<b>Dimensions • Baumaße</b>									
	<b>4390UNIV</b>	DN	B1	B2	D1	D2	D3	C	R	Rd x s	kg
	25			F04,F05	6,5		9				
	32			F04,F05	6,5		9				
	40			F04,F05	6,5		9				
	50 UNIV.	17	30,5	F05	7,5	6,5	9				
	65 UNIV.	17	30,5	F05	7,5	6,5	9				
	80 UNIV.	17	30,5	F05	7,5	6,5	9				
100 UNIV.	17	30,5	F05	7,5	6,5	9					

Bracket of pneumatic actuator - increased Haltekonsole - erhöht	<b>43901</b>	<b>Dimensions • Baumaße</b>									
		DN	L	D	D	E	G	R	L	Rd x s	kg
	50	52	F05								
	65	54	F05								
	80	54	F05								
	100	54	F05								

Bracket of pneumatic act. C for 43081 Haltekonsole C für 43081	<b>43906-C</b>	<b>Dimensions Baumaße</b>	
	DN	A	
	25-32	F04	
	40	F04	
	50-65	F05	

Bracket of pneumatic actuator D, AT for 43081 Haltekonsole D, AT für 43081	<b>43906-D</b>	<b>Dimensions Baumaße</b>	
	DN	A	
	25-32		
	40		
	50-65		
	80-100		

Driver for AT (S - R, D - A) Träger für AT (S - R, D - A)	<b>43940</b>	<b>Dimensions • Baumaße</b>									
		DN	A	D	D	E	G	R	L	Rd x s	kg
	9x9										
	11x11										
	14x14										
	17x17										
	22x22										

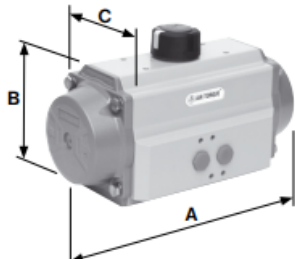
Pneumatic actuator spring return S-R Pneumatischer Antrieb L-F	<b>44050</b>	<b>Dimensions • Baumaße</b> [AIR-5 bar] [SGRING]										
		DN	A	B	C	Mk	Mk	F	R	L	Rd x s	kg
	SR 050	140,5	69	70,5	6,5 Nm	6,0 Nm						
	SR 100	158,5	85	83	11,2 Nm	10,0 Nm						
	SR 200	210,5	102	94,5	22,7 Nm	20,3 Nm						
	SR 250	247,5	115	106,3	33,3 Nm	30,0 Nm						
	SR 300	268,5	127	123	54,2 Nm	48,6 Nm						
	SR 400	345,0	145	141	117,0 Nm	102,0 Nm						

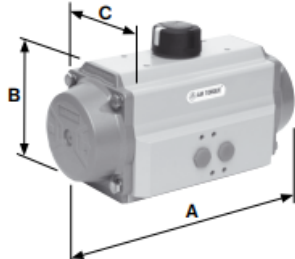
Pneumatic actuator double action D-A Pneumatischer Antrieb L-L	<b>44100</b>	<b>Dimensions • Baumaße</b> [AIR-5 bar]										
		DN	A	B	C	Mk	E	F	R	L	Rd x s	kg
	DA 050	140,5	69	70,5	14,8 Nm							
	DA 100	158,5	85	83	26,4 Nm							
	DA 200	210,5	102	94,5	56,1 Nm							
	DA 250	247,5	115	106,3	85,4 Nm							
	DA 300	268,5	127	123	133,0 Nm							
	DA 400	345,0	145	141	288,0 Nm							

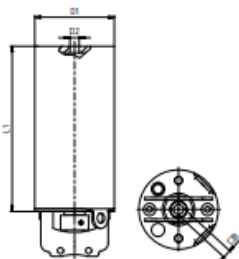
Pneumatic actuator D-A Pneumatischer Antrieb L-L	<b>4415C</b>	<b>Dimensions • Baumaße</b>										
		DN	A	B	D1	D2	L1	F	R	L	Rd x s	kg
	25 - 65		906	85	1/8"	174						

Mk max: 26 Nm  
 Working time (90°): 1,5 sec.  
 Weight: 3,85 kg  
 Working pressure (air): 5 - 9 bar

Maximum air pressure: 10 bar.  
 Volume of cylinder: 0,266 l  
 Working temperature: 10 - 140°C  
 (NBR)

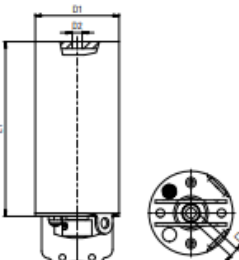
Pneumatic actuator S-R Pneumatischer Antrieb L-F	<b>4420C</b>	<b>Dimensions • Baumaße</b>										
		DN	A	B	D1	L2	F	G	R	L	Rd x s	kg
	25 - 65		85	248	9,5							

Mk max: 26 Nm  
 Working time (90°): 1,5 sec.  
 Weight: 3,85 kg  
 Working pressure (air): 5 - 9 bar

Maximum air pressure: 10 bar.  
 Volume of cylinder: 0,266 l  
 Working temperature: 10 - 140°C  
 (NBR)

Bracket of pneumatic actuator Haltekonsole	44140	Dimensions • Baumaße										
		DN	A	B	C	D	E	F	G	R	Rd x s	kg
	25	30,3	17,6	51,6	6	78						0,2
	32	30,3	17,6	55,2	6	82						0,3
	40	30,3	17,6	58,4	6	86						0,3

Pneumatic actuator D-A Pneumatischer Antrieb L-L	4415D	Dimensions • Baumaße										
		DN	D1	D2	B	L1	E	G	R	L	Rd x s	kg
	25	89	R 1/8"	9,5	175							2,5
	32	89	R 1/8"	9,5	175							2,5
	40	89	R 1/8"	9,5	175							2,5
	50	89	R 1/8"	9,5	175							2,5
	65	89	R 1/8"	9,5	175							2,5
	80	104	R 1/8"	9,5	175							4,1
	100	104	R 1/8"	9,5	175							4,1
	125	129	R 1/8"	14,0	175							7,2
	150	129	R 1/8"	14,0	175							7,2

Pneumatic actuator S-R Pneumatischer Antrieb L-F	4420D	Dimensions • Baumaße										
		DN	D1	D2	B	L1	F	F	R	L	Rd x s	kg
	25	89	R 1/8"	9,5	175							3,1
	32	89	R 1/8"	9,5	175							3,1
	40	89	R 1/8"	9,5	175							3,1
	50	89	R 1/8"	9,5	175							3,1
	65	89	R 1/8"	9,5	175							3,1
	80	104	R 1/8"	9,5	175							4,7
	100	104	R 1/8"	9,5	175							4,7
	125	129	R 1/8"	14,0	175							9,3
	150	129	R 1/8"	14,0	175							9,3

Signal contact arm Schaltfahne	44220	Dimensions • Baumaße										
		DN	L1	B	E	F	G	R	L	Rd x s	kg	
	25-100	72	20,3									
	125-150	94	30,3									

Holding device Halteblech für Nahrungsinitiator	44230	Dimensions • Baumae										
		DN	D1	D2	C	D	E	F	R	L	Rd x s	kg
	25-100	18,3	6									0,04
	25-100	12,3	6									0,04
	125-200	18,3	9									0,05
	125-200	12,3	9									0,05

Solenoid valve directly 3/2 Magnetventil direkt	44270	Dimensions • Baumae																					
		DN	A	B	C	D	E	F	R	L	Rd x s	kg											
	Anschluss / Air entry		G 1/8"		<b>Description</b> - Solenoid valve directly operated with 3/2- ways function - All entries have G 1/8" - Single stable version - Body Aluminium anodised, with minimal external dimensions - Giston Stainless steel AISI 303 - Sealings NBR - Screws Stainless steel AISI 304																		
	Nennweite / Dimension		1,3 mm		<b>Beschreibung</b> - Magnetventil direkt gesteuert mit 3/2- Wege Funktion - Alle Anschlusse haben G1/8" - Federruckstellung - Gehause Aluminium eloxiert, mit minimalen Auenabmessungen - Kolben Edelstahl 1.4305 - Dichtungen NBR - Schrauben Edelstahl 1.4301																		
Arbeitsdruck / Air pressure		0-10 bar		Temperatur / Temperature		-10 °C - +70 °C		Schutzart / Enclosure		GI 65 - DIN 40050		Spannung / Voltage		24V AC 24V DC 230V AC		Leistung / Gower consumption		5VA 3W 5VA		Nenndurchfluss / Air flow		50 l/min	

Solenoid valve Magnetventil	44300	Dimensions • Baumae																													
		DN	A	B	D1	D2	L1	F	R	L	Rd x s	kg																			
	<b>Description</b> - Solenoid valve NAMUR with combined 5/2 - and 3/2 - ways function with standard coil and connector - Easy change over from 5/2 - to 3/2 - ways operation by innovative sealing plate - Single stable version - Manual override as standard - Body Aluminium anodised, with minimal external dimensions - NAMUR coupling plate GA 6 - 30 % Glass fibre - Giston Stainless steel AISI 303, Sealings NBR, Screws Stainless steel AISI 304																														
	<b>Beschreibung</b> - Magnetventil NAMUR mit kombinierter 5/2 - und 3/2 - Wege Funktion mit Standardspule und Geratestecker - Leichtes Umschalten von 5/2 - auf 3/2 - Wege durch innovative Wendedichtung - Luftfederruckstellung - Serienmaig mit Notbetatigung - Gehause Aluminium eloxiert, mit minimalen Auenabmessungen - NAMUR Adapterplatte GA6 - 30% GF - Kolben Edelstahl 1.4305, Dichtungen NBR, Schrauben Edelstahl 1.4301																														
Anschluss / Air entry		G 1/4"		Nennweite / Dimension		5,5 mm		Arbeitsdruck / Air pressure		2-10 bar		Temperatur / Temperature		-10 °C - +50 °C		Schutzart / Enclosure		GI 65 - DIN 40050		Spannung / Voltage		24V AC 24V DC 230V AC		Leistung / Gower consumption		5VA 3W 5VA		Nenndurchfluss / Air flow		950 l/min	



# VALVES AND COCKS VENTILE UND HÄHNE

Proximity switch Näherungsinitiator	<b>44360</b>	<b>Dimensions • Baumaße</b>										
		DN	A	B	C	D	E	L	R	Rd x s	kg	
		M 12										

Suport of proximity switch Halteblech für Näherungsinitiator	<b>44370</b>	<b>Dimensions • Baumaße</b>										
		DN	A	B	D	D	E	G	R	L	Rd x s	kg

Noise silencer Schalldämpfer	<b>44420</b>	<b>Dimensions • Baumaße</b>										
		DN	G	L	C	D	E	F	R	L	Rd x s	kg
		G 1/8	G 1/8"	21,5								
		G 1/4	G 1/4"	26,5								

Screw union Schraubung	<b>44430</b>	<b>Dimensions • Baumaße</b>										
		DN	A	B	D	E	F	G	R	L	Rd x s	kg
		G 1/8 - 4	G 1/8"	4								
		G 1/8 - 6	G 1/8"	6								
		G 1/8 - 8	G 1/8"	8								
		G 1/8 - 10	G 1/8"	10								
		G 1/4 - 4	G 1/4"	4								
		G 1/4 - 6	G 1/4"	6								
		G 1/4 - 8	G 1/4"	8								
		G 1/4 - 10	G 1/4"	10								
		G 1/4 - 12	G 1/4"	12								



# VALVES AND COCKS VENTILE UND HÄHNE

Air connect 90° Air connect 90°	<b>44435</b>	<b>Dimensions • Baumaße</b>										
		DN	A	B	C	Mk	Mk	F	R	L	Rd x s	kg
			G1/8	D 4								
			G1/8	D 6								
			G1/8	D 8								
			G1/4	D 4								
			G1/4	D 6								
			G1/4	D 8								

Inductive proximity switches Induktive Näherungsschalter	<b>44450</b>	<b>Dimensions • Baumaße</b>										
		DN	A	B	C	Mk	E	F	R	L	Rd x s	kg

External nipple Externer nipple	<b>44500</b>	<b>Dimensions • Baumaße</b>										
		DN	G1	G2	C	D	E	F	R	L	Rd x s	kg
		1/4 - 1/4	G 1/4"	G 1/4"								
		1/4 - 1/8	G 1/4"	G 1/8"								
		1/8 - 1/8	G 1/8"	G 1/8"								
		3/8 - 3/8	G 3/8"	G 3/8"								

Suport of lower sensor Halteblech für Doppel-Näherungsinitiator	<b>44510</b>	<b>Dimensions • Baumaße</b>										
		DN	A	B	C	E	F	G	R	L	Rd x s	kg



# VALVES AND COCKS VENTILE UND HÄHNE

Electric drive Elektroantrieb	<b>44590</b>	<b>Dimensions • Baumaße</b>										
		DN	A	B	C	D	E	F	R	L	Rd x s	kg
		Max torque Nm	Type	SWITCH On-Off	SWITCH Gositioner	Operating time s/90°	Flange ISO	Gower kW	Current rated A	Current start A		
		<b>85-260VAC 50-60HZ</b>										
	70	AQT7L	Yes	Yes	15	F05/F07	0.02	0.4	1			
										<b>24V DC</b>		
	70	AQT7L	Yes	Yes	15	F05/F07	0.02	0.5	6			

Control box Steuerkopf	<b>44710-C3</b>	<b>Dimensions • Baumaße</b>									
		DN	A	B	C	D	E	F	R	L	Rd x s
		<b>TYPES: 44710 C3 EKO</b> - air manifold GOM + 2x micro switch, LED <b>44710 C3 STANDARD</b> - air manifold GOM + 2x proximity sensor, LED <b>44710 C3 MAX</b> - air manifold 1.4301 + 2x proximity sensor, LED									
		<b>POSITION SENSING:</b> micro switch: 12 - 30 V proximity sensor: 12 - 30 V <b>SOLENOID VALVE:</b> 24 V DC <b>LED LIGHTING:</b> 3W (red and green) <b>AIR CONNECTION:</b> for compressed air hose 6/4 <b>TEMPERATURE OF ENVIRONMENT:</b> -15°C to +60°C									

Digital electropneumatic positioner Elektropneumatischer Stellungsregler	<b>44800</b>	<b>Dimensions • Baumaße</b>																																																																														
		DN	A	B	C	E	F	F	R	L	Rd x s	kg																																																																				
	<p>The robust and compact positioner is designed to standardisation acc. to IEC 534-6 or VDI/VDE 3845 for assembly with linear and rotary actuators. In addition, the remote version with the displacement position sensor can be com-bined with Bürkert process control valves. The digital electropneumatic positioner SideControl can be operated with the usual current and voltage standard signals and can also be equipped with the fieldbus interface GROBUS DGV1. Additionally to the digital graphic display the valve opening is signaled by a mechanical indicator element.</p> <p>Operation occurs via the external operation and display module. It consists of a backlit graphical display and a robust transparency keyboard with four keys with software driven function indication. For the user operation is very simple and clear, identical to the Bürkert positioner or process controller TopControl, Type 8692/8693.</p> <p>The pilot valve system can be used equally for single and doubleact-ing drives. It is characterised by a defined safety feature in case of failure of the electrical or pneumatic power supply and possesses an enormous air capacity range with pressure supply up to 7 bar.</p>																																																																															
	<table border="1"> <tr> <td>Material Body Seal</td> <td>Aluminium plastic-coated EGDm, NBR, FKM</td> </tr> <tr> <td>Operating voltages</td> <td>24 VDC +/- 10%</td> </tr> <tr> <td>Residual ripple</td> <td>max. 10%</td> </tr> <tr> <td>Setpoint setting</td> <td>0/4 to 20 mA and 0 to 5/10 V</td> </tr> <tr> <td>Input resistance</td> <td>0/4 to 20 mA: 180 Ω 0 to 5/10 mA: 19 kΩ</td> </tr> <tr> <td>Analogue feedback</td> <td>4 - 20 mA, 0 - 20 mA 0 - 10 V, 0 - 5 V</td> </tr> <tr> <td>Binary input</td> <td>galvanically isolated, 0 - 5 V = log "0", 10 - 30 V = log "1"</td> </tr> <tr> <td>Binary output</td> <td>2 Outputs (optional), galvanically separated</td> </tr> <tr> <td>Current limit</td> <td>100 mA, Output will be synchronised when overloaded</td> </tr> <tr> <td>Control medium</td> <td>Neutral gases, air DIN ISO 8573-1</td> </tr> <tr> <td>Dust concentration</td> <td>Class 5 (&lt; 40 µm particle size)</td> </tr> <tr> <td>Particle density</td> <td>Class 5 (&lt; 10 mg/m³)</td> </tr> <tr> <td>Gressure condensation point</td> <td>Class 3 (&lt; -20°C)</td> </tr> <tr> <td>Oil concentration</td> <td>Class 5 (&lt; 25 mg/m³)</td> </tr> <tr> <td>Ambient temperature</td> <td>0 to +6°C</td> </tr> <tr> <td>Glilot air ports</td> <td>Threaded ports G 1/4</td> </tr> <tr> <td>Supply pressure</td> <td>1,4 to 7 bar<sup>1)</sup></td> </tr> <tr> <td>Air supply filter</td> <td>Exchangeable (aperture size ~ 0,1 mm)</td> </tr> <tr> <td>Actuator system</td> <td>single and double-acting to 150 l/min.</td> </tr> <tr> <td>Air capacity</td> <td>95 l/min. (with 1,4 bar<sup>1)</sup>) for aeration and ventilation 150 l/min (with 6 bar<sup>1)</sup>) for aeration and ventilation QVn = 100 lNp/min (acc. to the definition with decrease in pressure from 7 to 6 bar absolute)</td> </tr> <tr> <td>Position detection module</td> <td>Gottmeter, max. angle 1800</td> </tr> <tr> <td>Stroke range valve spindle</td> <td>min. 30° on the rotary shaft, depending on lever</td> </tr> <tr> <td>Installation</td> <td>as required, display above or sideways</td> </tr> <tr> <td>Type of protection</td> <td>IG 65/67 acc. to EN 60529 (NEMA4x in preparation)</td> </tr> <tr> <td>Gower consumption</td> <td>&lt; 5 W</td> </tr> <tr> <td>Electrical connection</td> <td>M12, 8-pin/4-pin; M8, 4-pin</td> </tr> <tr> <td>Multipole connection</td> <td>2x M 20 x 1,5 (cable Ø 10 mm) on screw terminals (0,14 - 1,5 mm<sup>2)</sup></td> </tr> <tr> <td>Cable gland</td> <td>1x M 12 x 1,5 (cable Ø 3 to 6,5 mm)</td> </tr> <tr> <td>Remote version</td> <td></td> </tr> <tr> <td>Bus communication</td> <td>Groß bus DGV1 (optional)</td> </tr> <tr> <td>Inductive proximity switch</td> <td>on request</td> </tr> <tr> <td>Protection class</td> <td>3 acc. to VDE 0580</td> </tr> <tr> <td>Type of ignition protection</td> <td>II 3 G nA II B T4 (in preparation) II 3 D ID A22 T135° (in preparation)</td> </tr> <tr> <td>Conformity</td> <td>EMV2004/108/EG</td> </tr> <tr> <td>Approvals</td> <td>CSA (in preparation)</td> </tr> </table>										Material Body Seal	Aluminium plastic-coated EGDm, NBR, FKM	Operating voltages	24 VDC +/- 10%	Residual ripple	max. 10%	Setpoint setting	0/4 to 20 mA and 0 to 5/10 V	Input resistance	0/4 to 20 mA: 180 Ω 0 to 5/10 mA: 19 kΩ	Analogue feedback	4 - 20 mA, 0 - 20 mA 0 - 10 V, 0 - 5 V	Binary input	galvanically isolated, 0 - 5 V = log "0", 10 - 30 V = log "1"	Binary output	2 Outputs (optional), galvanically separated	Current limit	100 mA, Output will be synchronised when overloaded	Control medium	Neutral gases, air DIN ISO 8573-1	Dust concentration	Class 5 (< 40 µm particle size)	Particle density	Class 5 (< 10 mg/m³)	Gressure condensation point	Class 3 (< -20°C)	Oil concentration	Class 5 (< 25 mg/m³)	Ambient temperature	0 to +6°C	Glilot air ports	Threaded ports G 1/4	Supply pressure	1,4 to 7 bar <sup>1)</sup>	Air supply filter	Exchangeable (aperture size ~ 0,1 mm)	Actuator system	single and double-acting to 150 l/min.	Air capacity	95 l/min. (with 1,4 bar <sup>1)</sup> ) for aeration and ventilation 150 l/min (with 6 bar <sup>1)</sup> ) for aeration and ventilation QVn = 100 lNp/min (acc. to the definition with decrease in pressure from 7 to 6 bar absolute)	Position detection module	Gottmeter, max. angle 1800	Stroke range valve spindle	min. 30° on the rotary shaft, depending on lever	Installation	as required, display above or sideways	Type of protection	IG 65/67 acc. to EN 60529 (NEMA4x in preparation)	Gower consumption	< 5 W	Electrical connection	M12, 8-pin/4-pin; M8, 4-pin	Multipole connection	2x M 20 x 1,5 (cable Ø 10 mm) on screw terminals (0,14 - 1,5 mm <sup>2)</sup>	Cable gland	1x M 12 x 1,5 (cable Ø 3 to 6,5 mm)	Remote version		Bus communication	Groß bus DGV1 (optional)	Inductive proximity switch	on request	Protection class	3 acc. to VDE 0580	Type of ignition protection	II 3 G nA II B T4 (in preparation) II 3 D ID A22 T135° (in preparation)	Conformity	EMV2004/108/EG	Approvals	CSA (in preparation)
Material Body Seal	Aluminium plastic-coated EGDm, NBR, FKM																																																																															
Operating voltages	24 VDC +/- 10%																																																																															
Residual ripple	max. 10%																																																																															
Setpoint setting	0/4 to 20 mA and 0 to 5/10 V																																																																															
Input resistance	0/4 to 20 mA: 180 Ω 0 to 5/10 mA: 19 kΩ																																																																															
Analogue feedback	4 - 20 mA, 0 - 20 mA 0 - 10 V, 0 - 5 V																																																																															
Binary input	galvanically isolated, 0 - 5 V = log "0", 10 - 30 V = log "1"																																																																															
Binary output	2 Outputs (optional), galvanically separated																																																																															
Current limit	100 mA, Output will be synchronised when overloaded																																																																															
Control medium	Neutral gases, air DIN ISO 8573-1																																																																															
Dust concentration	Class 5 (< 40 µm particle size)																																																																															
Particle density	Class 5 (< 10 mg/m³)																																																																															
Gressure condensation point	Class 3 (< -20°C)																																																																															
Oil concentration	Class 5 (< 25 mg/m³)																																																																															
Ambient temperature	0 to +6°C																																																																															
Glilot air ports	Threaded ports G 1/4																																																																															
Supply pressure	1,4 to 7 bar <sup>1)</sup>																																																																															
Air supply filter	Exchangeable (aperture size ~ 0,1 mm)																																																																															
Actuator system	single and double-acting to 150 l/min.																																																																															
Air capacity	95 l/min. (with 1,4 bar <sup>1)</sup> ) for aeration and ventilation 150 l/min (with 6 bar <sup>1)</sup> ) for aeration and ventilation QVn = 100 lNp/min (acc. to the definition with decrease in pressure from 7 to 6 bar absolute)																																																																															
Position detection module	Gottmeter, max. angle 1800																																																																															
Stroke range valve spindle	min. 30° on the rotary shaft, depending on lever																																																																															
Installation	as required, display above or sideways																																																																															
Type of protection	IG 65/67 acc. to EN 60529 (NEMA4x in preparation)																																																																															
Gower consumption	< 5 W																																																																															
Electrical connection	M12, 8-pin/4-pin; M8, 4-pin																																																																															
Multipole connection	2x M 20 x 1,5 (cable Ø 10 mm) on screw terminals (0,14 - 1,5 mm <sup>2)</sup>																																																																															
Cable gland	1x M 12 x 1,5 (cable Ø 3 to 6,5 mm)																																																																															
Remote version																																																																																
Bus communication	Groß bus DGV1 (optional)																																																																															
Inductive proximity switch	on request																																																																															
Protection class	3 acc. to VDE 0580																																																																															
Type of ignition protection	II 3 G nA II B T4 (in preparation) II 3 D ID A22 T135° (in preparation)																																																																															
Conformity	EMV2004/108/EG																																																																															
Approvals	CSA (in preparation)																																																																															



# VALVES AND COCKS VENTILE UND HÄHNE

Digital electropneumatic positioner  
Elektropneumatischer Stellungsregler

44801

Dimensions • Baumaße

The compact positioner Type 8692 is optimized for integrated mounting on the pneumatic actuators in the process valve series Type 23xx/2103 and is specially designed for the requirements of a hygienic process environment. The control air channel is integrated in the actuator without external tubings. The easy handling and the selection of additional software functions are done either on a big graphic display with backlight and keypad or over COMMUNICATOR.



The positioner registers the valve position without deterioration through a contact-free, analog position sensor. The control of single or double-acting actuators is done without internal air consumption. With integrated diagnostic functions operation conditions of the control valve can be monitored. Through status signals, valve diagnostic messages are transmitted according to NAMUR NE107 and recorded as history entries.

The housing is easy to clean and features proven IP protection and chemically resistant materials for use in hygienic processing, in food, beverage and pharmaceutical industries. Combined with Bürkert ELEMENT actuators the unique pilot valve system enables a compressed air recycling that avoids actuator chambers contamination from the environment.

DN	A	B	C	E	F	F	R	L	Rd x s	kg
<b>Technical data</b>										
<b>Material</b>		Body	PPS, stainless steel							
		Cover	PC							
		Sealing	EPDM							
<b>Power supply</b>		24 V DC ± 10 % UL: NEC Class 2								
<b>Residual ripple</b>		max. 10 %								
<b>Setpoint setting</b>		0/4 to 20 mA and 0 to 5/10 V								
<b>Output resistance</b>		0/4 to 20 mA: 180 Ω 0 to 5/10 V: 19 k Ω								
<b>Control medium</b>		neutral gases, air, quality classes acc. to ISO 8573-1								
		Dust concentration	Class 7 (<40 µm particle size)							
		Particle density	Class 5 (<10 mg/m <sup>3</sup> )							
		Pressure condensation point	Class 3 (<-20 °C)							
		Oil concentration	Class X (<25 mg/m <sup>3</sup> )							
<b>Ambient temperature</b>		-10 to +55 °C								
<b>Pilot air ports</b>		Threaded ports G <sup>1</sup> / <sub>8</sub> stainless steel or								
<b>Supply pressure</b>		Low air flow rate 0 to 7 bar <sup>1</sup> High air flow rate 3 to 7 bar								
<b>Air input filter</b>		Exchangeable (mesh aperture=0.1 mm)								
<b>Actuator system</b>										
		Actuator series Type 23xx	Low air flow rate : Ø Actuator 70/90 mm High air flow rate : Ø Actuator 130 mm							
		Actuator series Type 27xx	High air flow rate : Ø Actuator 175/225 mm							
<b>Position detection module</b>		Contact-free, wear-free								
<b>Stroke range valve spindle</b>		3 to 45 mm								
<b>Installation</b>		as required, preferably with actuator in upright position								
<b>Protection type</b>		IP65/IP67 acc. to EN 60529, Type 4X acc. to NEMA 250 standard								
<b>Protection class</b>		3 acc. to DIN EN 61140								
<b>Power consumption</b>		<5 W								
<b>Electrical connection</b>										
		Multipole connection	M12, 8-pins or 4-pins							
		Cable gland	2xM16 x 1.5 (cable-Ø 5-10 mm) with connection terminals for cable cross-sections 0.14-1.5 mm <sup>2</sup>							
<b>Bus communication</b>		PROFIBUS DP-V1, DeviceNet, EtherNet/IP, PROFINET, Modbus TCP, bus - Bürkert System Bus (based on CANopen)								

Leakage butterfly valves S-S  
Leckage Scheibenventil S-S

45611

Dimensions • Baumaße

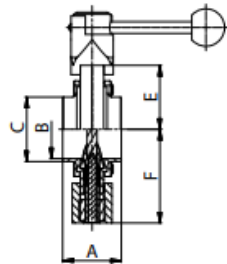

DN	A	B	C	E	F	G	R	L	Rd x s	kg
40	50	38	43	48,5	71					
50	50	50	55	55	80					
65	50	66	72	63,5	89					

Leakage butterfly valves G-S  
Leckage Scheibenventil G-S

45612

Dimensions • Baumaße

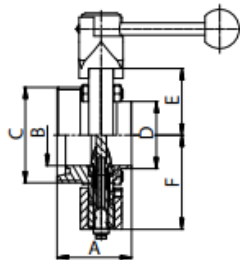

DN	A	B	C	D	E	F	R	L	Rd x s	kg
			<b>DIN 405</b>							
40	61	38	65x1/6"	43	48,5	71				
50	61	50	78x1/6"	55	55	80				
65	63	65	95x1/6"	72	63,5	89				

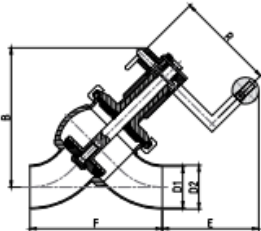

Inline seat valve S - S, Type - Y Inline - ventyl S - S, Typ - Y	<b>47290</b>	<b>Dimensions • Baumaße</b>										
		<b>DN</b>	<b>R</b>	<b>B</b>	<b>C</b>	<b>D1</b>	<b>D2</b>	<b>E</b>	<b>F</b>	<b>L</b>	<b>Rd x s</b>	<b>kg</b>
		25	60	124		26	29	69	111,8			
		40	120	160		38	41	117	145,4			
		50	120	168		50	53	115	159,0			
		65	120	198		66	70	122	187,2			
		80	120	204		81	85	113	205,9			

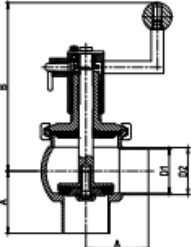
Angle seat valve S - S, Type - L Eckventil S - S, Typ - L	<b>47300</b>	<b>Dimensions • Baumaße</b>										
		<b>DN</b>	<b>A</b>	<b>B</b>	<b>C</b>	<b>D1</b>	<b>D2</b>	<b>F</b>	<b>R</b>	<b>L</b>	<b>Rd x s</b>	<b>kg</b>
		25	50	135		26	29					
		40	60	181		38	41					
		50	70	189		50	53					
		65	80	218		66	70					
		80	90	219		81	85					

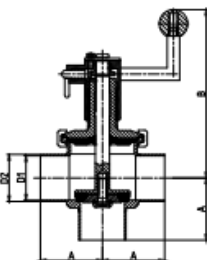
Double angle seat valve S - S - S, Type - T Doppel eckventil S - S - S, Typ - T	<b>47310</b>	<b>Dimensions • Baumaße</b>										
		<b>DN</b>	<b>A</b>	<b>B</b>	<b>C</b>	<b>D1</b>	<b>D2</b>	<b>G</b>	<b>R</b>	<b>L</b>	<b>Rd x s</b>	<b>kg</b>
		25	50	135		26	29					
		40	60	181		38	41					
		50	70	189		50	53					
		65	80	218		66	70					
		80	90	219		81	85					

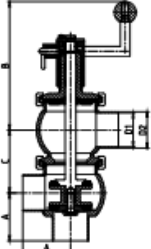
Change over valve S - S - S, Type - LL Umstellventil S - S - S, Typ - LL	<b>47320</b>	<b>Dimensions • Baumaße</b>										
		<b>DN</b>	<b>A</b>	<b>B</b>	<b>C</b>	<b>D1</b>	<b>D2</b>	<b>F</b>	<b>R</b>	<b>L</b>	<b>Rd x s</b>	<b>kg</b>
		25	50	119	56,6	26	29					
		40	60	184	80,0	38	41					
		50	70	188	92,4	50	53					
		65	80	221	120,0	66	70					
		80	90	226	128,0	81	85					



# VALVES AND COCKS VENTILE UND HÄHNE

Inline seat valve S - S, Type - Y, pneumatic Inline - ventil S - S, Typ - Y, pneumatisch	<b>4729 C-P45</b>	<b>Dimensions • Baumaße</b>									
	<b>NC</b>	<b>DN</b>	<b>A</b>	<b>B</b>	<b>D1</b>	<b>D2</b>	<b>E</b>	<b>F</b>	<b>L</b>	<b>Rd x s</b>	<b>kg</b>
	25		47,0	26	29	60	111,8				
	40		277,7	38	41	85	145,4				
	50		284,1	50	53	85	159,0				
	65		357,8	66	70	133	187,2				
	85		360,9	81	85	133	205,9				

Angle seat valve S - S, Type - L, pneumatic Eckventil S - S, Typ - L, pneumatisch	<b>4730 C-P45</b>	<b>Dimensions • Baumaße</b>									
	<b>NC</b>	<b>DN</b>	<b>A</b>	<b>B</b>	<b>C</b>	<b>D1</b>	<b>D2</b>	<b>E</b>	<b>L</b>	<b>Rd x s</b>	<b>kg</b>
	25	50	147,0			26	29	60			
	40	60	277,7			38	41	85			
	50	70	284,1			50	53	85			
	65	80	357,8			66	70	133			
	85	90	360,9			81	85	133			

Double angle seat valve S - S - S, Type - T, pneumatic Doppel eckventil S - S - S, Typ - T, pneumatisch	<b>4731 C-P45</b>	<b>Dimensions • Baumaße</b>									
	<b>NC</b>	<b>DN</b>	<b>A</b>	<b>B</b>	<b>C</b>	<b>D1</b>	<b>D2</b>	<b>E</b>	<b>L</b>	<b>Rd x s</b>	<b>kg</b>
	25	50	147,0			26	29	60			
	40	60	277,7			38	41	85			
	50	70	284,1			50	53	85			
	65	80	357,8			66	70	133			
	85	90	360,9			81	85	133			

Change over valve S - S - S, Type - LL, pneumatic Umstellventil S - S - S, Typ - LL, pneumatisch	<b>4732 C-P45</b>	<b>Dimensions • Baumaße</b>									
	<b>NC</b>	<b>DN</b>	<b>A</b>	<b>B</b>	<b>C</b>	<b>D</b>	<b>E</b>	<b>R</b>	<b>L</b>	<b>Rd x s</b>	<b>kg</b>
	25	50	147,0	56,6	26	29	60				
	40	60	277,7	80,0	38	41	85				
	50	70	284,1	92,4	50	53	85				
	65	80	357,8	120,0	66	70	133				
	85	90	360,9	128,1	81	85	133				



**Butterfly valve with pneumatic actuator 4415C (4420C)**

- variants signaling and control (solenoid valve x control box)

**Scheibenventil mit Pneumatischeantriebe 4415C (4420C)**

- varianten signalisierung und kontrolle (magnetventil x steuerkopf)

Position detection – Positionserfassungs

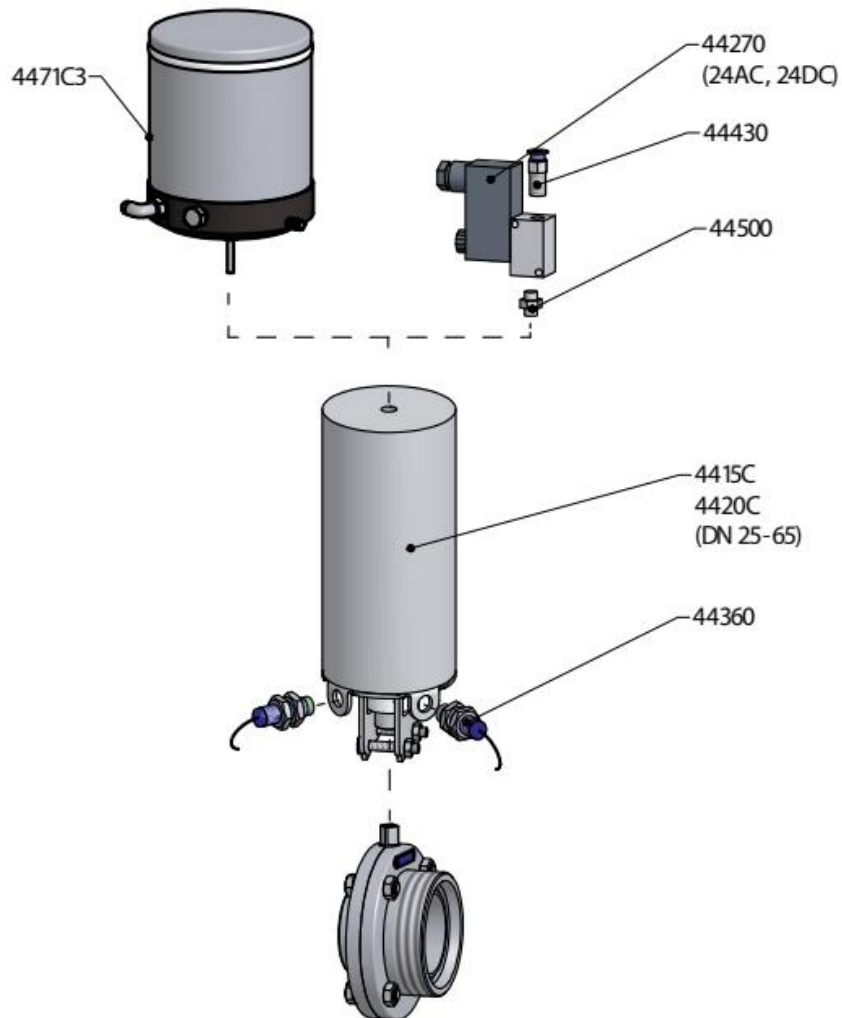

**Butterfly valve with pneumatic actuator 4415D (4420D) - variants signaling and control**

**Scheibenventil mit pneumatischeantriebe 4415D (4420D) - varianten signalisierung und kontrolle**

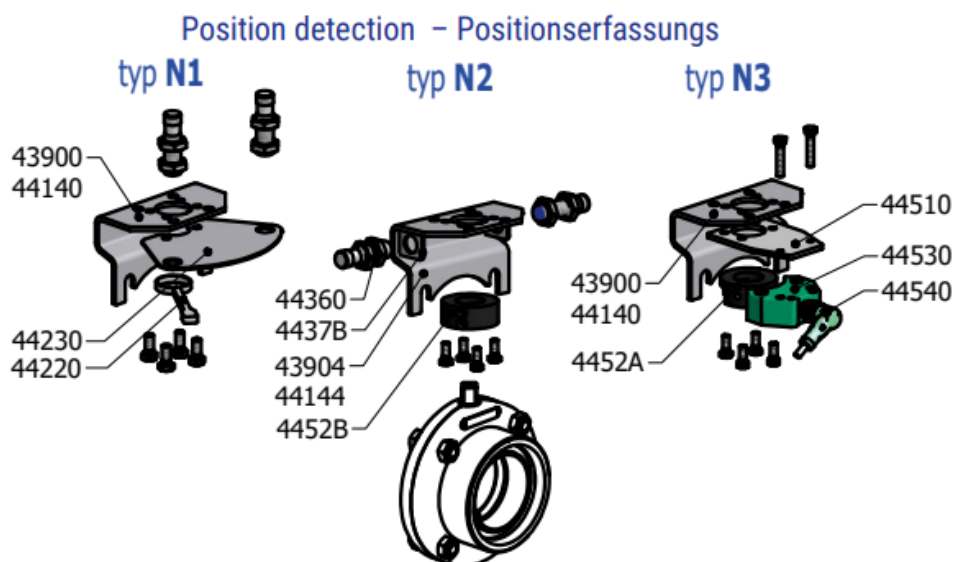
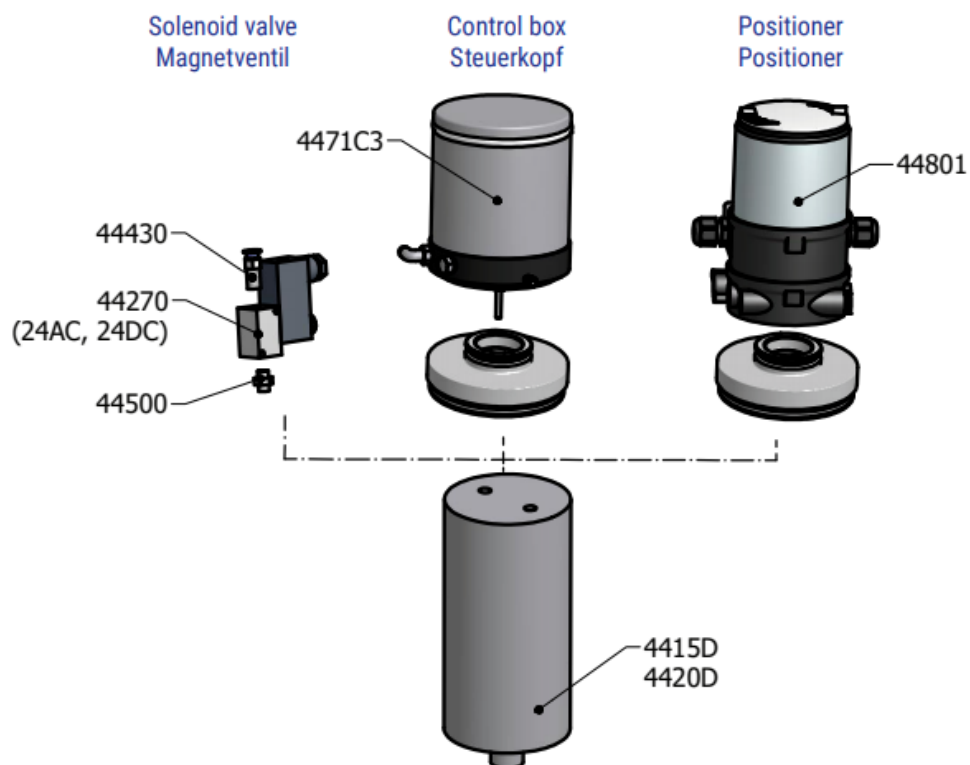

**Butterfly valve with pneumatic actuator Air Torque - variants signaling and control**

**Scheibenventil mit pneumatischantriebe Air Torque - varianten signalisierung und kontrolle**

## Position detection – Positionserfassungs

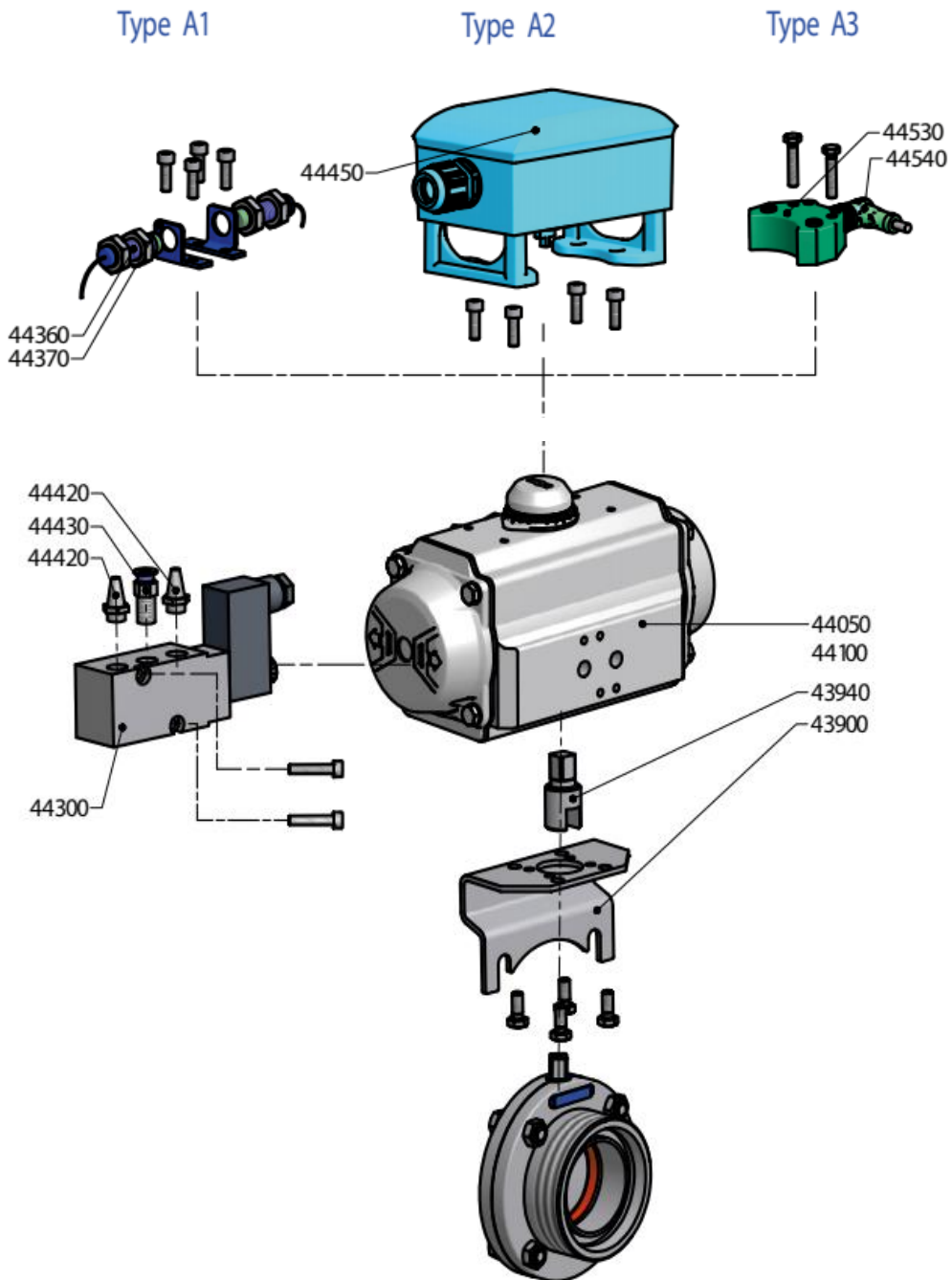

Flap and pneumatic actuator (4415C, 4420C) assembly with control head  
Klappe und pneumatischer Antrieb (4415C, 4420C) mit Steuerkopf

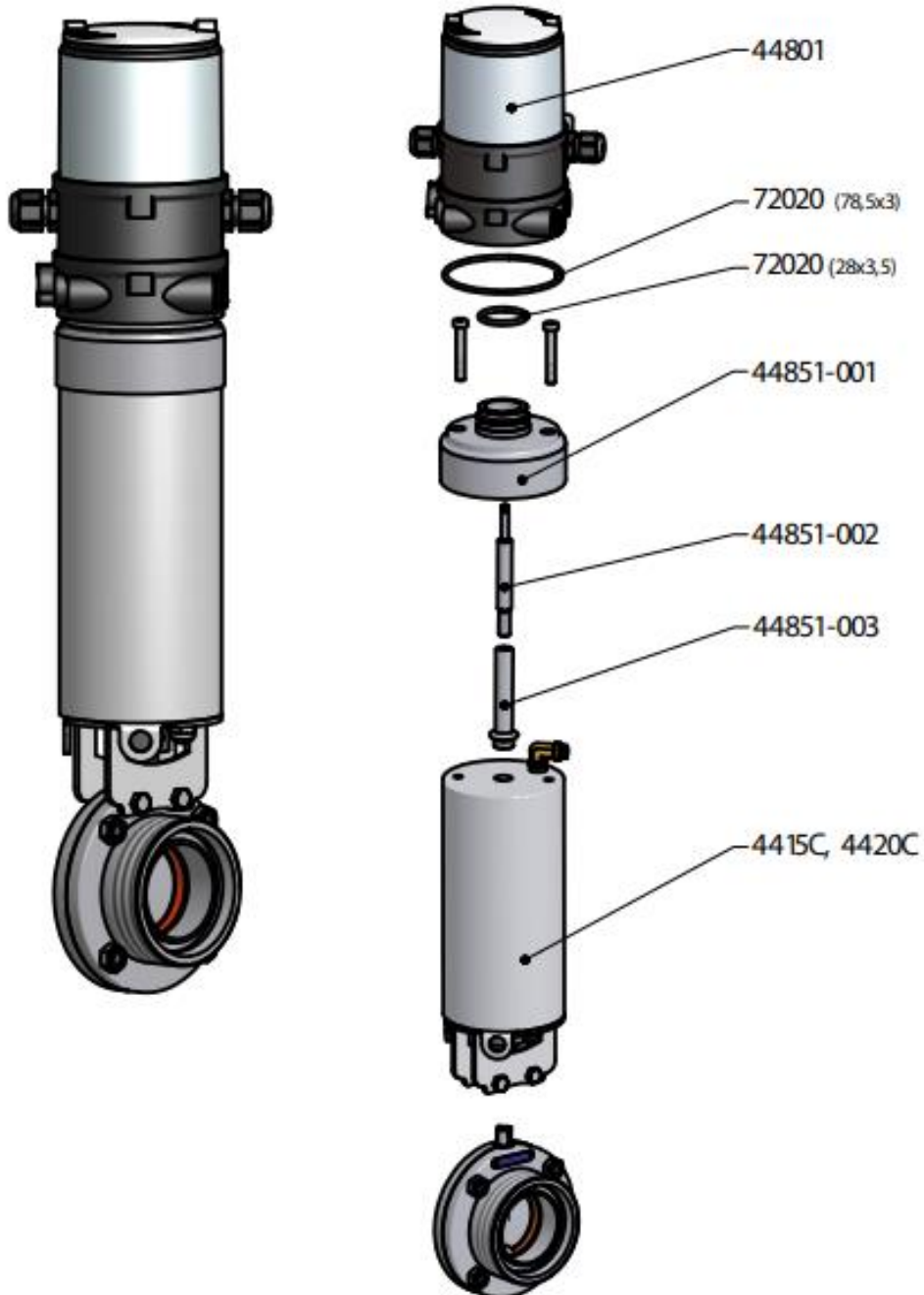

Flap and pneumatic actuator (4415D, 4420D) assembly with control head  
Klappe und pneumatischer Antrieb (4415D, 4420D) mit Steuerkopf

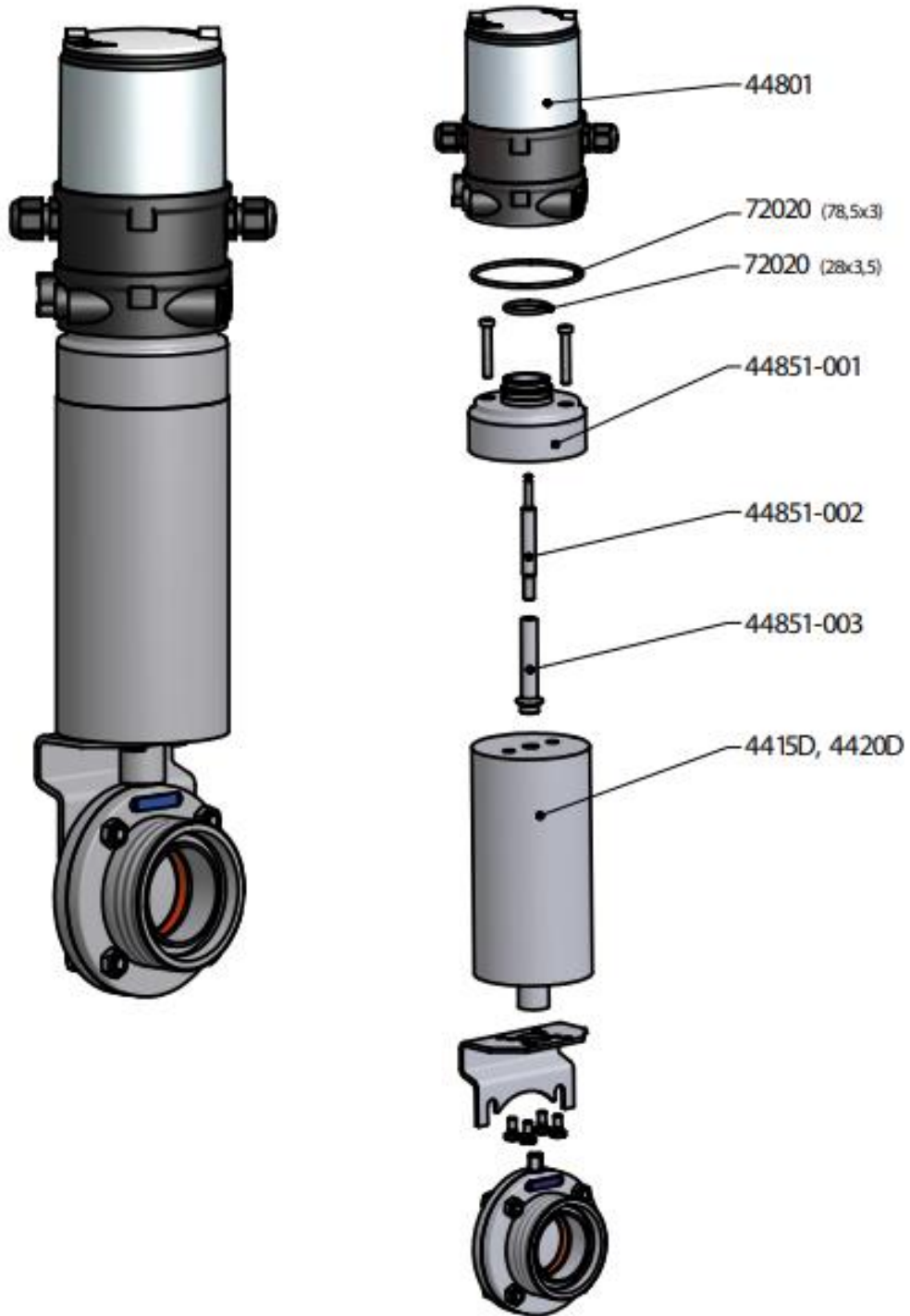



## VALVES AND COCKS VENTILE UND HÄHNE

Butterfly valve with electric drive  
Scheibenventil mit Elektroantrieb

